

Dimensions and data sheet -- VIVA Sugar Dispenser

Installation location requirements

All bremer appliances are ready for operation when supplied. Before appliance installation, the required site connections must be pre-installed and easily accessible. This preparation work must be performed by qualified specialists in accordance with applicable regulations. The distance of the bremer appliance to the wall must be at least 4 cm (for air circulation). Leave sufficient space above (minimum 300 mm) to be able to fill sugar.

Electrical connection

The product is supplied with earthing contact plug; ensure that an easily accessible earthing contact socket is available. A connection must be made to the potential equalisation system. For increased safety, we recommend adding a fault current safety switch.

Design: 230 V, 1 N, 50 Hz, 0.2 kW, fuse 1x16 A

Performance

Output: approx. 1,000 servings / hr.
 Metering range: metered, portioned dispensing
 Content storage container: 2 kg

Seitenansicht / sideview
 Milch/Zucker
 milk/sugar

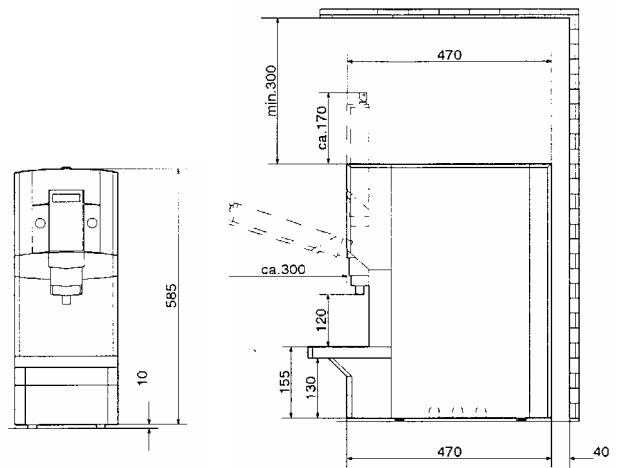

Stellfläche / space required
 Milch/Zucker
 milk/sugar

Stellfläche / space required
 Milch/Zucker
 milk/sugar

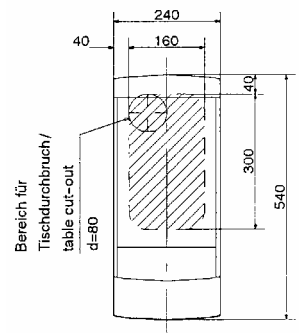

Table cut-out d=80 possible within the shaded area!

Weight: Sugar Dispenser 19 kg

