

Dimensions and data sheet -- VIVA Milk Dispenser (coffee cream)

Installation location requirements

All bremer appliances are ready for operation when supplied. Before appliance installation, the required site connections must be pre-installed and easily accessible. This preparation work must be performed by qualified specialists in accordance with applicable regulations. The distance of the bremer appliance to the wall must be at least 4 cm (for air circulation). Leave sufficient space above (min. 300 mm) to be able to fill the milk (coffee cream).

Electrical connection

The product is supplied with earthing contact plug; ensure that an easily accessible earthing contact socket is available.

A connection must be made to the potential equalisation system. For increased safety, we recommend adding a fault current safety switch.

Design: 230 V, 1 N, 50 Hz, 0.2 kW, fuse 1 x 16 A

Performance

Output: approx. 1,200 servings / hr.

Metering range: non-metered withdrawal

Storage container content: 2 litres

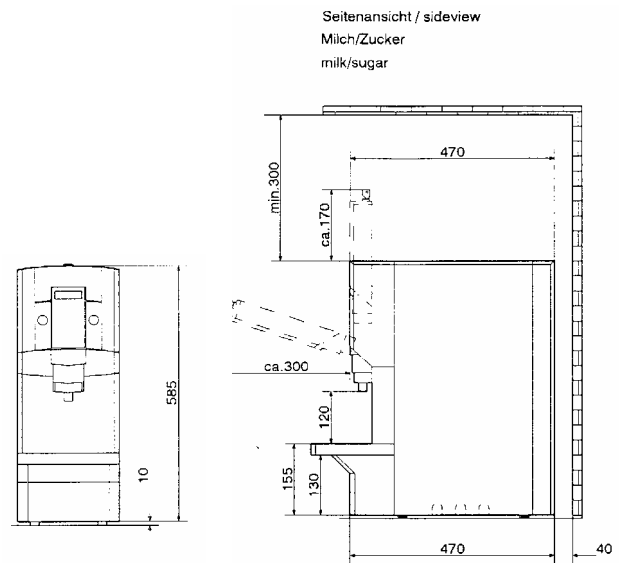

Stellfläche / space required
Milch/Zucker
milk/sugar

Stellfläche / space required
Milch/Zucker
milk/sugar

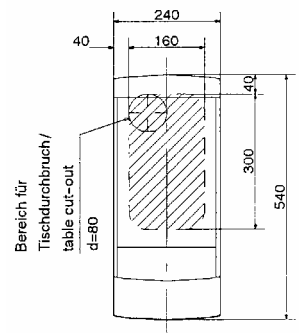

Table cut-out d=80 possible within the shaded area!

Weight: Milk Dispenser 17 kg

